

724 First Ave N., Billings MT 59101 (406)245-6981

## Preliminary Measurements & Images Guide

Name: \_\_\_\_\_  
 Email: \_\_\_\_\_

Phone Number: \_\_\_\_\_

The following steps will guide you through the process of capturing the information your Design Consultant will need.

This is a preliminary step to capture some measurements and pictures.

Don't worry about getting it perfect. Your Design Consultant will conduct a professional site measurement once you progress to the next step, which is the formal design of your dream kitchen!

What you will need:

A printed copy of this guide to record your dimensions



A tape measure



A pen or pencil



Your phone for pictures



Optional: Graph Paper if you want to draw your space

### Measuring the space

1. What shape best represents is your kitchen layout?

One-Wall Layout



Galley Layout

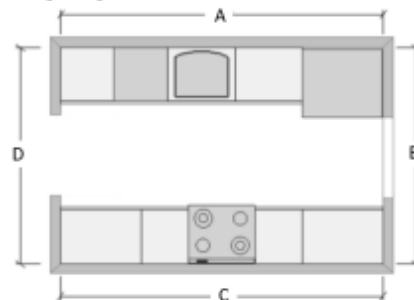

□ L-Shaped Layout

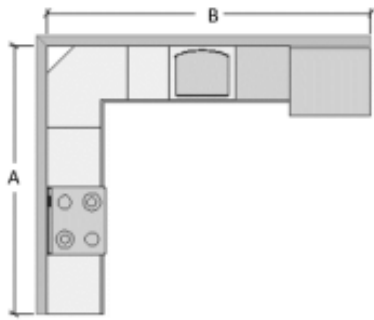

□ One-Wall with Island Layout

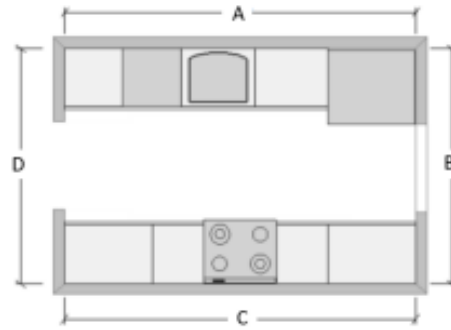

□ L-Shape with Island Layout



□ U-Shape with Island Layout

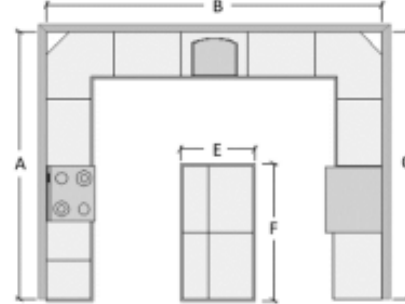

□ Double Island

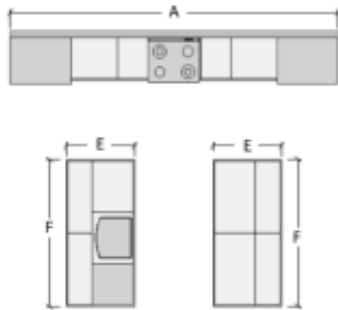

□ Peninsula Layout

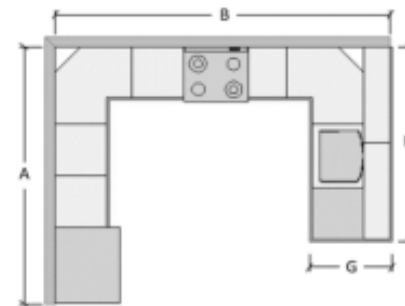

□ G-Shaped Layout

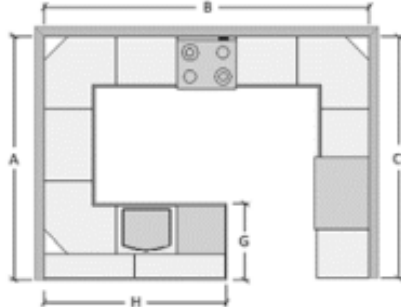

□ Double L Layout

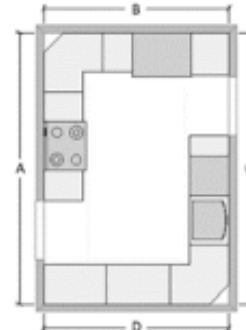

2.Using the diagram of your kitchen shape, please provide these wall measurements.

Wall A \_\_\_\_\_

Wall B \_\_\_\_\_

Wall C \_\_\_\_\_

Wall D \_\_\_\_\_

3.If you have an island, what is the overall size of the island?

Width E \_\_\_\_\_

Length F \_\_\_\_\_

4.If you have a peninsula, what is the size of it?

Width G \_\_\_\_\_

Length H \_\_\_\_\_

5.What is the ceiling height in your kitchen?

Height \_\_\_\_\_

### **Photographing the space**

Ideally you want to capture the whole space so your Design Consultant can have a “look” at your room. Taking a video of the room can also be helpful.

6.Take a picture of each wall you measured

Wall A

Wall B

Wall C

Wall D

7.Take a few pictures of the overall space

Picture 1

Picture 2

8.Optional: Take a video of the room.

Video